

Date:

West Bengal Real Estate Regulatory Authority

Calcutta Green's Commercial complex, 1st Floor,

1050/2, Survey Park, Kolkata- 700075.

Sub: Location Details of Project

Sir,

We are enclosing herewith the location details of the project NIRMALA AASTHA, with clear demarcation of land dedicated for the project along with its boundaries including the latitude and longitude of the end points of the project.

Thanking you

Yours faithfully,

Shree Ram Infra Nirman Pvt. Ltd.

Aayush Tekrinal

Director

Shree Ram Infra Nirman Pvt. Ltd.

312, Lake Town, Block-A
Kolkata - 700 89 | Mobile : 75959 27970
E-mail : nirmalagroup4u@gmail.com

SITE PLAN OF A PLOT OF LAND SITUATED AT HOLDING NO.- 571, BANGUR AVENUE, KOLKATA-700055; PLOT NO.-11, BLOCK-D, BANGUR AVENUE; C.S. DAG NO.-2528/2529; C.S. KHATIAN NO.-33/46; RESANO.-180; TOUZI NO.-228 & 229; J.L.NO.-17; MOUZA-KRISHNAPUR; P.S.-LAKE TOWN; DIST.- NORTH 24 PGS WITHIN THE LIMITS OF SOUTH DUMDUM MUNICIPALITY.

TOTAL LAND AREA = 5 K. 1 CH. 23 SFT. WITH G+I STD. STRUCTURE (MORE OR LESS)

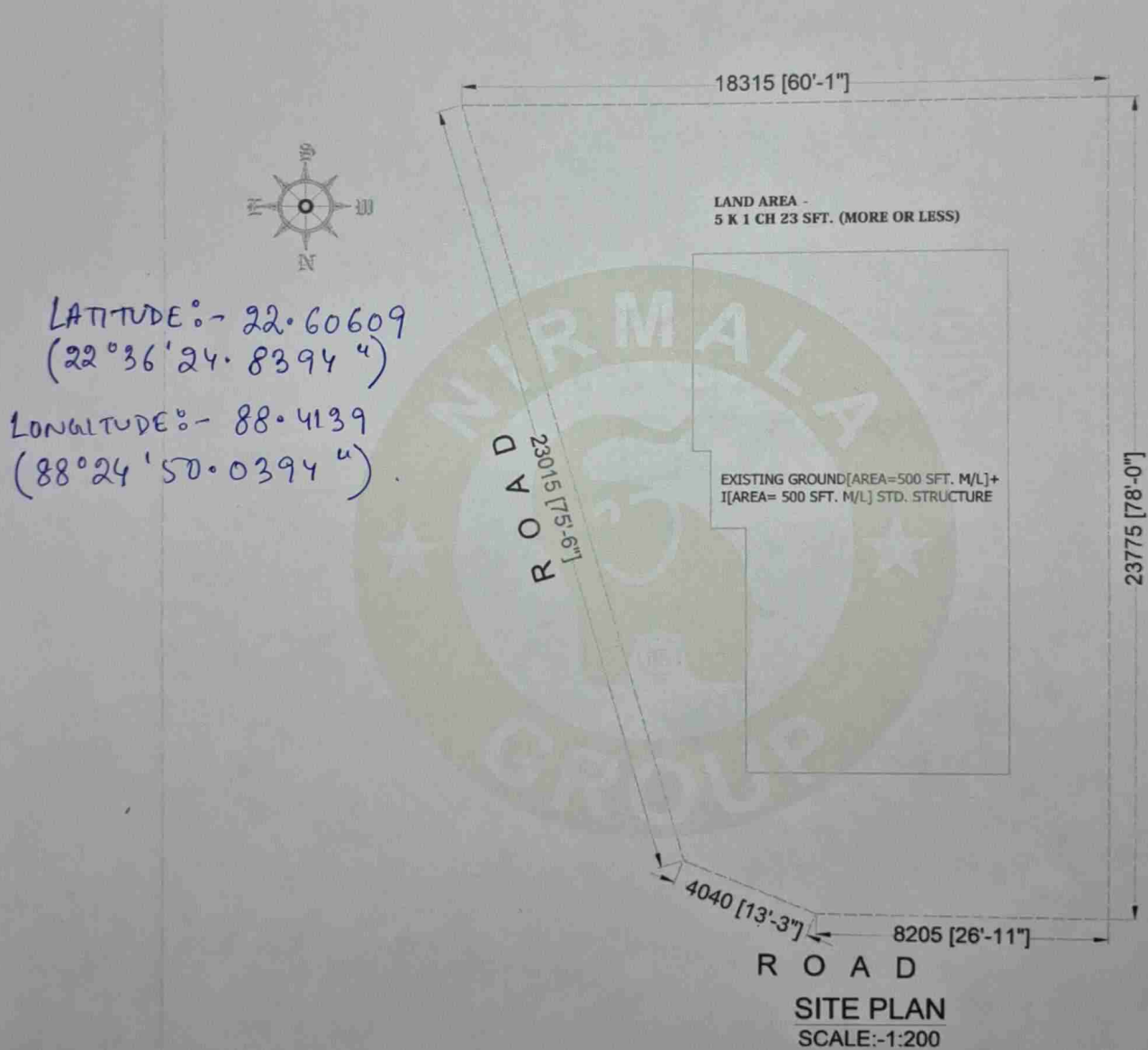

Shree Ram Infra Nirman Pvt. Ltd.
Aayush Tekmal
Director